



## STREET HEAT KIT INSTALLATION INSTRUCTIONS

Congratulations! You are about to install one of the finest automotive aftermarket graphics manufactured today. When properly applied, you can expect the Sharpline Street Heat™ graphic to last for years under normal conditions.

For best results, please read this instruction sheet in its entirety before installation. Pay special attention to the "Surface Preparation" and "Graphic Care Guidelines" found on the back page.

While there are several acceptable methods to install vinyl graphics, this instruction sheet details our recommended method. Novices and professionals alike can find the installation steps detailed here useful in providing the most efficient, error free graphic application possible.

### BEFORE INSTALLATION

Read this instruction sheet in its entirety.

Be sure you have these items:

- 1- Squeegee
- 1- Snappy™ knife
- 3/4" Masking tape
- Isopropyl alcohol and clean cotton rags

### PACKAGE CONTENTS

Your Sharpline Street Heat™ kit contains a drivers side & passenger side set of 4 panels:

| ITEM                              | SIZE         |
|-----------------------------------|--------------|
| Rear Qtr. Panel Flame Graphic     | 2 1/8" x 47" |
| Rear Qtr. Panel/Door Stripe Panel | 59" long     |
| Door Stripe Panel                 | 3/8" x 59"   |
| Front Fender Stripe Panel         | 52" long     |

Prior to installation, carefully pull apart all the graphic components. Separate the components into driver-side and passenger-side groups.

1



Starting with the driver side of the vehicle, tape all the graphic components into their desired location.

2



Once you are satisfied with the location of the graphic components, secure the rear quarter 'flame' panel to the vehicle using the "center hinge" method. Start by running a strip of masking tape through the center of the component. Then secure each end of the component with another piece of masking tape.

3

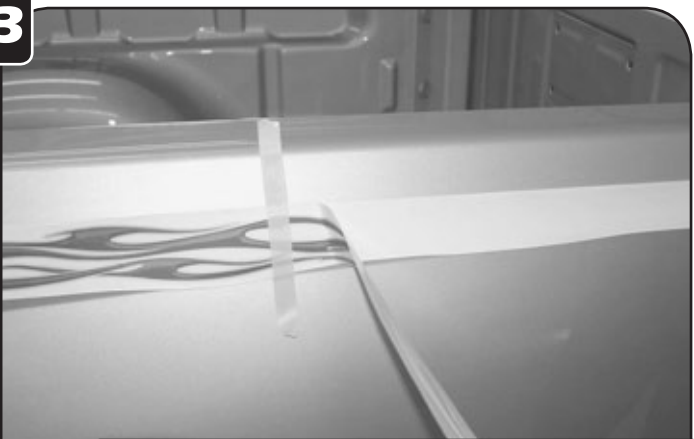

Remove the positioning tape on one side of the center hinge and peel the masking and the graphic away from the liner paper (backing paper) for this portion of the graphic.

4

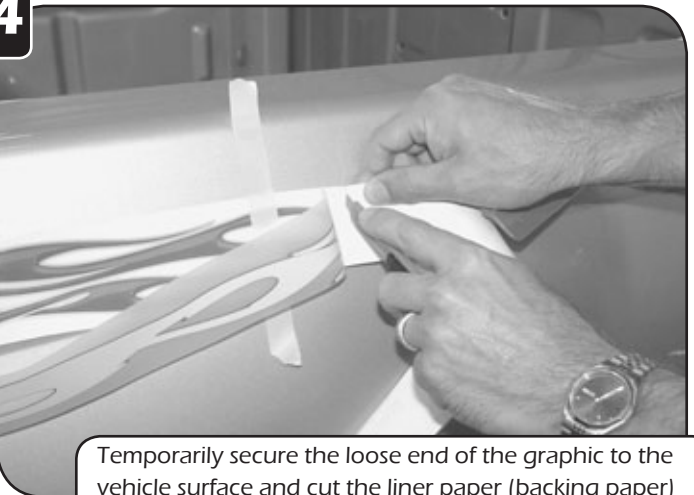

Temporarily secure the loose end of the graphic to the vehicle surface and cut the liner paper (backing paper) near the center hinge and discard.

5

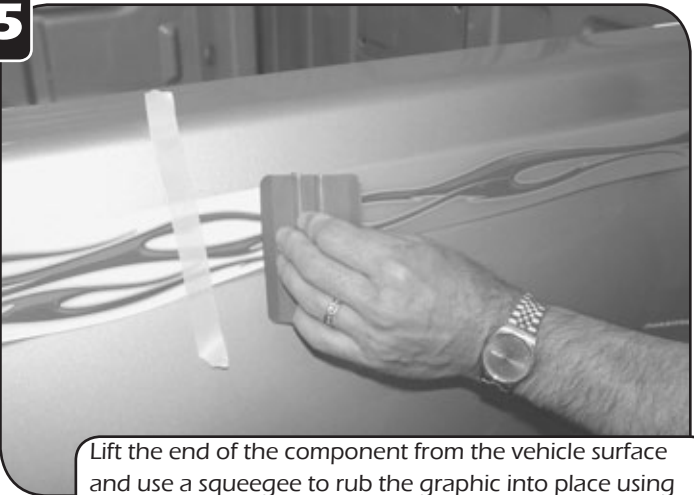

Lift the end of the component from the vehicle surface and use a squeegee to rub the graphic into place using short, overlapping strokes that go vertically from the center of the graphic to the edge. Be sure to start at the hinged area and move toward the end.

6



Remove the masking tape 'hinge' from the center of the graphic component. Then remove the remaining liner paper (backing paper) from the graphic component and discard. Squeegee the remaining half of the panel onto the vehicle utilizing the same method described in step #5.

7

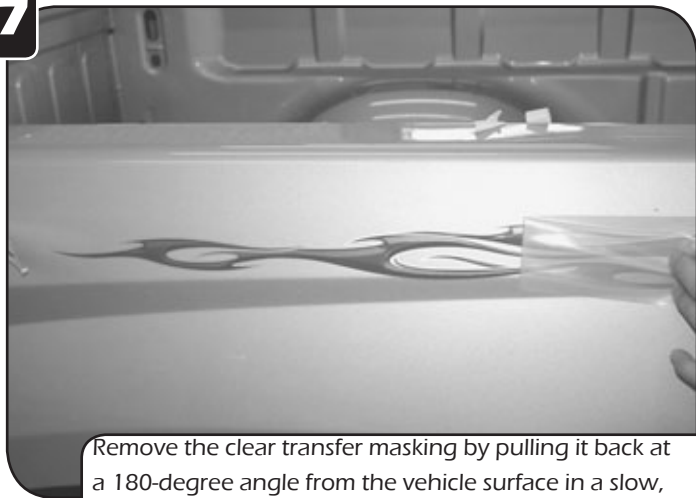

Remove the clear transfer masking by pulling it back at a 180-degree angle from the vehicle surface in a slow, smooth, and steady motion.

8



Install the graphic strip panel with the larger flame on one end next. Use the 'center hinge method' described in Steps 2 - 7 to install this graphic strip.

9

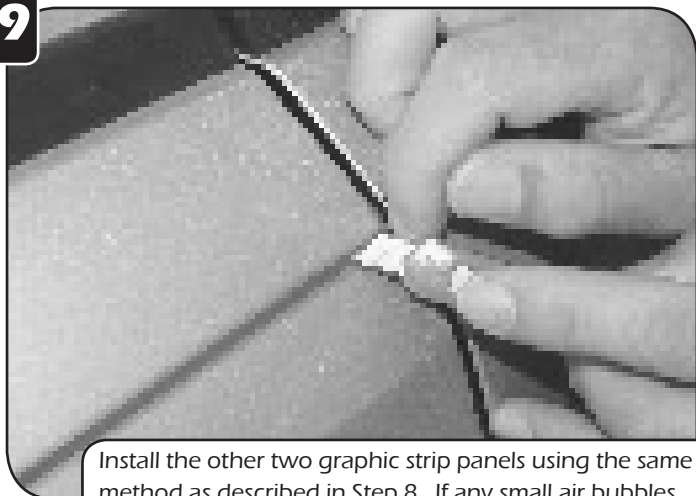

Install the other two graphic strip panels using the same method as described in Step 8. If any small air bubbles have remained under the graphic during installation, they can be removed by pricking the base of the bubble with your knife blade and squeezing the trapped air out with the tip of your finger or the squeegee.

10

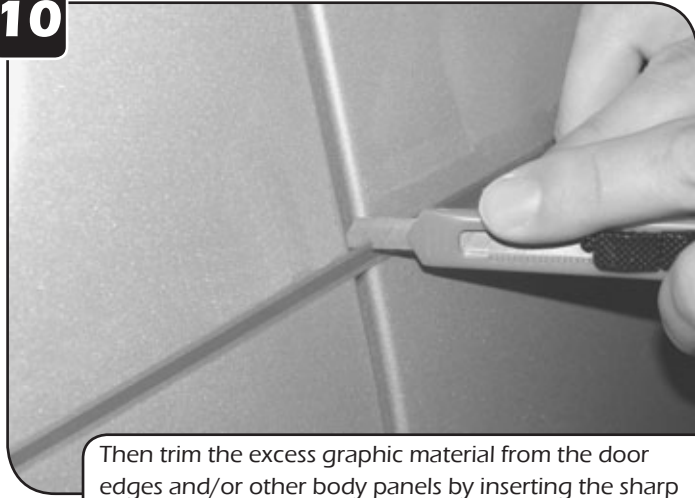

Then trim the excess graphic material from the door edges and/or other body panels by inserting the sharp knife along the edge of the material at a 45-degree angle. Then, carefully cut through the vinyl along both sides of the gap.

11

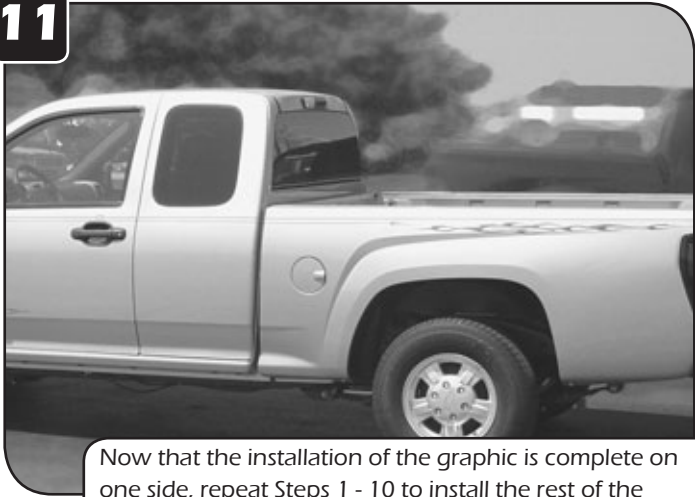

Now that the installation of the graphic is complete on one side, repeat Steps 1 - 10 to install the rest of the Street Heat™ kit on the remaining side of the vehicle.

## SURFACE PREPARATION

The vehicle surface must be properly prepared prior to installation of the graphics. All surfaces **MUST** be cleaned before any application of vinyl material. Use the following steps:

1. For best results the installation should take place in temperatures ranging from 50 to 90 degrees Fahrenheit. Do not install outdoors if winds exceed 10 mph. Blown dirt, dust, or other contaminants can interfere with the bonding of the graphic adhesive to the vehicle during installation.
2. Wash the surface of the vehicle with detergent and water, then thoroughly rinse with water and dry completely. **WARNING:** Do not use any aromatic solvents such as acetone, M.E.K., toluene, paint thinner, lacquer thinner, gasoline, or ammonia-based cleaners to clean the vehicle surface.
3. Saturate a clean cloth with isopropyl alcohol and wipe the surface of the vehicle where the graphic is to be applied to remove any contaminants such as silicone, wax, or adhesives.
4. Dry the surface with a lint-free cotton towel.

## GRAPHIC CARE GUIDELINES

*This Sharpline Street Heat™ graphic is designed for superior durability and requires little maintenance. Please follow the steps below to get the best performance.*

Wash your graphic with soap and water or car wash detergents. Rinse thoroughly.

Keep high-pressure nozzles at least 1 1/2 feet away from the edge of the graphic when washing. High-pressure spray can lift the edge of the graphic and cause it to peel.

DO NOT overcoat the graphic with clear coat of any kind.

DO NOT let gasoline or other fuels drip or stay on the graphic for any length of time. If a spill occurs, wipe off the graphic and rinse with water immediately.

DO NOT use petroleum based solvents on your graphics. They will soften the vinyl and damage the color.

DO NOT apply wax over graphics, especially if the wax contains any petroleum or silicone distillates. Car wax will not improve the finish of graphics and can damage the surface after repeated exposure. If you wax your vehicle, wax that has dried along the edge of the graphic can be removed by first softening it with rubbing alcohol and cotton swabs. Be sure to rinse the area after cleaning.

